



STANDARD CONSTRUCTION

MATERIAL:
26 GAUGE ASTM A-653 HOT-DIPPED GALVANIZED STEEL SHEET

CONSTRUCTION:
MECHANICALLY RIVETED / STITCH WELDED

STANDARD SIZES:

PLAIN	LENGTH	WIDTH	DIAMETER	GAUGE	QTY.
RTR644	6"	4"	4"	26	1
RTR844	8"	4"	4"	26	1
RTR866	8"	6"	6"	26	1
RTR1066	10"	6"	6"	26	1
RTR1088	10"	8"	8"	26	1
RTR1244	12"	4"	4"	26	1
RTR1266	12"	6"	6"	26	1
RTR1288	12"	8"	8"	26	1
RTR121010	12"	10"	10"	26	1
RTR1466	14"	6"	6"	26	1
RTR1488	14"	8"	8"	26	1
RTR141010	14"	10"	10"	26	1
RTR141212	14"	12"	12"	26	1

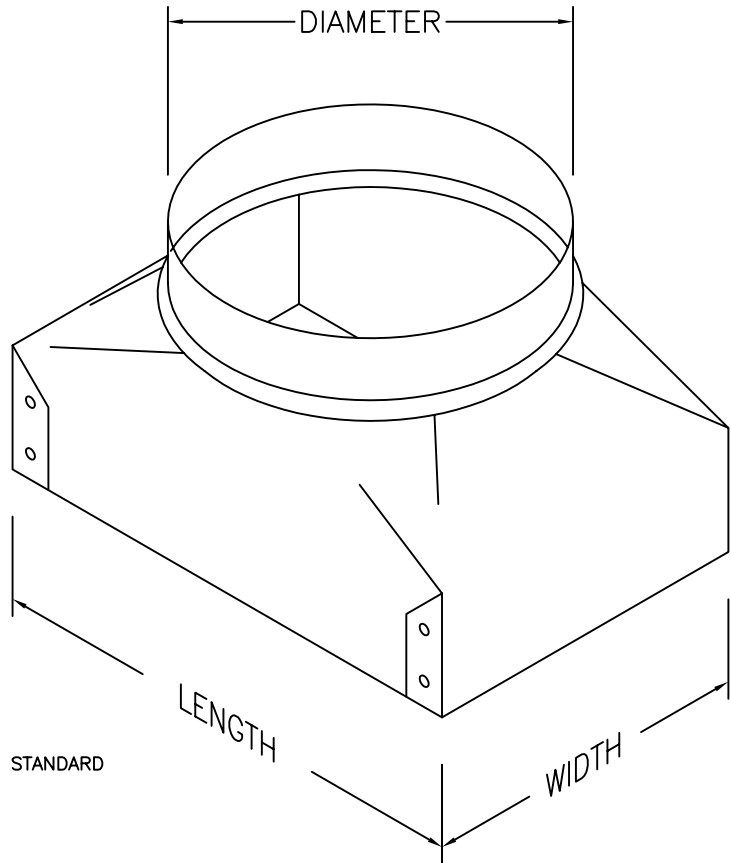

STANDARD

FEATURES

GALVANIZED STEEL PROVIDES EXCELLENT CORROSION RESISTANCE AND LONGEVITY.

RECTANGULAR END FITS OVER GRILLE NECK.

ROUND COLLAR IS OVERSIZED WITH A BEAD TO ACCEPT PIPE OR FLEXIBLE DUCT.

OPTIONS: CUSTOM SIZES AVAILABLE.
FLANGED PERIMETER AVAILABLE

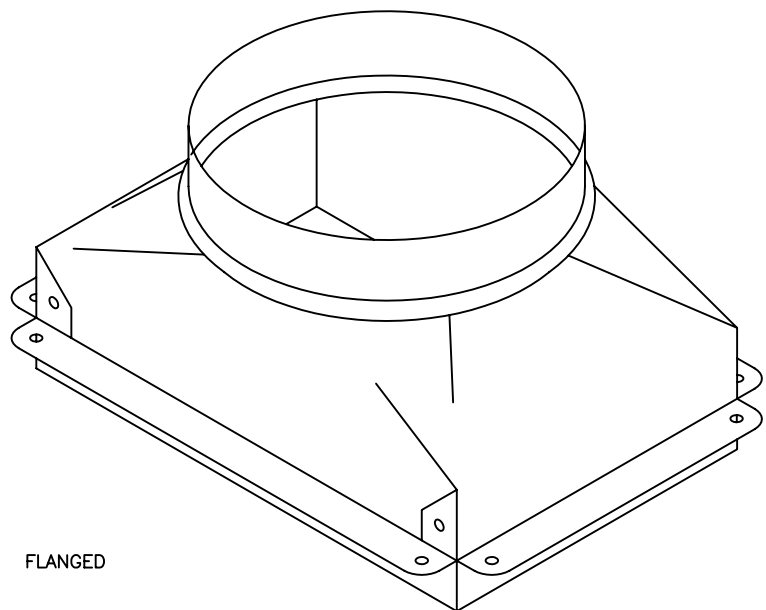

FLANGED

JOB NAME:
LOCATION:
ARCHITECT:
ENGINEER:
CONTRACTOR:
CONTACT MIAMI TECH INC. FOR ADDITIONAL INFORMATION OR WITH SPECIAL REQUIREMENTS. 3611 NW 74TH ST MIAMI, FL 33147 PHONE: 305-693-7054 FAX: 305-693-6152 WEB: WWW.MIAMITECH.COM EMAIL: SALES@MIAMITECH.COM

RTR

RECTANGULAR TO ROUND ADAPTER
PRODUCT SPECIFICATIONS

NOTE: ALL DRAWINGS SUBJECT TO CHANGE WITHOUT PRIOR NOTICE.



DRAWN BY: AF

DATE: 10/10/07

SCALE: NOT TO SCALE

DRAWING NO.

CHECKED BY: IG

DATE: 10/10/07

REVISION: 1

RTR